

# Specification sheet

# LF 190

FA 4X2 Rigid, 16t

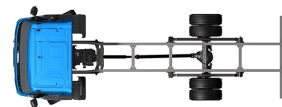

## ENGINES

- LF 190 PX-5 (139 kW / 189 hp)
- LF 210 PX-5 (153 kW / 208 hp)
- LF 230 PX-7 (167 kW / 227 hp)
- LF 260 PX-7 (189 kW / 257 hp)
- LF 290 PX-7 (212 kW / 287 hp)

## GVM<sup>1)</sup>

16000 kg

## GCM<sup>2)</sup>

16000 kg

Max. front 6000 kg

Max. rear 10500 kg

067F4602ABAA - 202345C - 21-08-2023

Greece, ERGOTRAK, [www.daftrucks.gr](http://www.daftrucks.gr)

## CAB EXTERIOR

Day Cab with steel bumper, tinted glass and electric window openers. Main mirrors and wide angle mirrors electrically heated. Cab width 2130 mm.; Green tinted glass; Electrically adjustable mirrors; Mirror brackets, body 2.50-2.60 m; Front view mirror.

### Optional

<b>02576</b> Extended Day Cab	<b>07343</b> Kerb view window co-driver door
<b>02106</b> Sleeper Cab	
<b>03175</b> Cab suspension rubber and mechanical	<b>00915</b> Side no glass / rear single glass
<b>01605</b> Cab suspension mechanical reinforced	<b>09101</b> Green tinted glass, heated
<b>09983</b> Fog lights	<b>09282</b> Mirror brackets, body 2.30-2.40 m
<b>09984</b> Fog lights and cornering lights	<b>09283</b> Mirror brackets, body 2.40-2.50 m

## AERODYNAMICS

### Optional

<b>09287</b> Side collars prepared	<b>07112</b> Side collars long (set)
------------------------------------	--------------------------------------

## COLOURS

; Head lamp panel and bumper: Stone Grey; Chassis colour grey..

### Optional

<b>06150</b> Solid cab colour	<b>04431</b> Special metallic cab colour
<b>00061</b> Special solid cab colour	
<b>06151</b> Cab metallic colour	<b>06485</b> Head lamp panel and bumper: cab colour
	<b>16153</b> Cab and chassis colours

## CAB INTERIOR

Mechanically adjustable steering column; Driver seat: air suspended; Co-driver seat: fixed velour; Storage box on engine tunnel.

### Optional

<b>09271</b> Steering wheel, leather, colour black	<b>00967</b> Seat belts red
<b>03516</b> Pneumatically adjustable steering column	<b>04346</b> Lower bunk, normal level
<b>06012</b> Co-driver seat: fixed vinyl	<b>02213</b> Air conditioning
<b>03376</b> Dual mate seat, vinyl	<b>03703</b> Auxiliary cab heater Air Top 2000
<b>00072</b> Dual mate seat, velour	<b>04246</b> Roof hatch, manual control
<b>02600</b> Co-driver seat: air suspended	<b>04258</b> Roof hatch, electric control
<b>09106</b> Dual mate seat, luxury version	

## COMMUNICATION AND DRIVING MANAGEMENT

FMS connector, prepared; Tachograph digital, Stoneridge 1C version G2V2; Adaptive Cruise Control with FCW and AEBS-3.

### Optional

<b>16155</b> Audio equipment, makes and types
---

## SAFETY AND SECURITY

Lane Departure Warning System; Vehicle Stability Control (VSC); Basic engine immobiliser system.

### Optional

<b>08631</b> Air bag (driver) and 2 seat belt tensioners	<b>06634</b> Immobiliser 5 minutes and alarm (SCM BV03-B2)
<b>01725</b> Reverse warning	<b>06635</b> Immobiliser 15 minutes and alarm (SCM BV03-B3)
<b>07414</b> Reverse warning with self-adjusting volume	
<b>06633</b> Immobiliser 5 minutes (SCM BV03-B1)	<b>16156</b> EC-ADR packages

## SUSPENSION AND AXLES

Front axle type F60. Parabolic leaf suspension with shock absorbers and stabiliser. Max. load 6.0 tonnes.; Single reduction driven rear axle type SR10.22 with parabolic leaf suspension, including shock absorbers and stabiliser. Max. load 10.5 tonnes..

### Optional

<b>00948</b> Rear axle SR10.26	<b>01372</b> Rear springs air
--------------------------------	-------------------------------

## WHEELS AND TYRES

Front axle(s): 285/70R19.5; Driven rear axle(s): 285/70R19.5; Wheel protection rings silvergrey.

### Optional

<b>06764</b> Wheel protection rings black	<b>16152</b> Tyre makes and types
---	-----------------------------------

## DRIVELINE

Engine PX-5, 4 cylinder diesel engine, 4.5 litres. Output 139 kW (189 hp) at 2300 rpm. Max. torque 745 Nm at 1200-1700 rpm.; Exhaust emission Euro 6; Engine idle shutdown, 5 minutes; Manual gearbox, 6 speeds; Gearbox ratio 6.58-0.78; Rear axle ratio 4.56.

### Optional

<b>04393</b> Manual gearbox, 9 speeds	<b>09888</b> Automatic gearbox, 5 speeds
<b>07667</b> Automatic gearbox PowerLine, 8-speed	<b>02313</b> Gearbox direct drive

## BRAKE SYSTEM

Exhaust brake.

## CHASSIS

Wheelbase 4.20 m / rear overhang 2.27 m; Side member height 270 mm; EAS unit right, discharge right rearward; Plastic fuel tank 170 l; Tank for AdBlue® 30 l, right-hand side chassis; Front underrun protection (FUP); Spray suppression.

### Optional

<b>07071</b> Spare wheel carrier right-hand side	<b>03323</b> Rear light with LEDs
--	-----------------------------------

## DRAWBAR AND TRAILER EQUIPMENT

Closing member.

### Optional

<b>04661</b> D-value cross member D=8.5
---

## BODIES AND PREPARATIONS FOR BODYING

No BodyBuilder Module (BBM); Application connector chassis; Standard body attachment hole pattern.

### Optional

- |       |  |       |  |
|-------|--|-------|--|
| 09952 | BodyBuilder Module (BBM) full                | 01503 | Side marker lights                           |
| 02597 | Application connector for tail lift control  | 07487 | Body attachment BAM 1, loose consoles supply |
| 02950 | Application connector for hydraulic platform | 07488 | Body attachment BAM 3, loose consoles supply |
| 09240 | Application connector for refuse collector   |       |  |

## POWER TAKE-OFF (PTO)

### Optional

- |       |   |       |   |
|-------|---|-------|---|
| 06624 | Indirect front engine PTO                         | 01250 | Front engine PTO with generator preparation 30 kW |
| 00590 | Front engine PTO with generator preparation 17 kW | 16148 | PTO types and positions                           |
| 06785 | Front engine PTO, generator preparation 22.5 kW   |       |   |

## 24V POWER SUPPLY

Alternator 80 A, batteries 2x 125 Ah..

### Optional

- |       |                  |       |                   |
|-------|------------------|-------|-------------------|
| 01897 | Alternator 100 A | 08797 | Batteries 2x175Ah |
|-------|------------------|-------|-------------------|

## GVM AND GCM

Chassis weight related technical GVM max 16000 kg; Driveline related technical GCM equal to GVM.

### Optional

- |       |                                    |       |   |
|-------|------------------------------------|-------|---|
| 00738 | Driveline related max GCM 24000 kg | 00620 | Driveline related max GCM 28000 kg            |
| 02658 | Driveline related max GCM 26000 kg | 03700 | Driveline related technical GCM = GVM+3500 kg |

## APPLICATION CONDITIONS

Moisture separator, unheated; Air intake low.

### Optional

- |       |                            |       |                            |
|-------|----------------------------|-------|----------------------------|
| 02270 | Cold climate               | 09960 | Air intake on the cab roof |
| 04767 | Moisture separator, heated | 04987 | Radiator flyscreen         |
| 04482 | Air intake high behind cab |       |                            |

## VEHICLE DELIVERY

Standard toolkit.



Go to [DAF.com](https://www.daf.com) to configure your own perfect DAF.

# LF 190

FA 4X2 Rigid, 16t

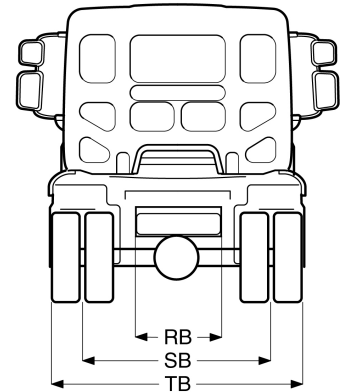
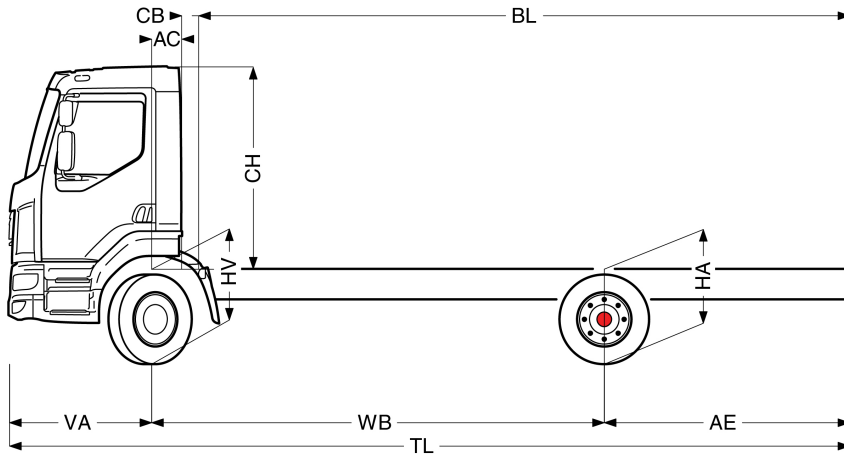

	Wheelbase - AE <sup>5)</sup>		Unladen weight <sup>1)</sup>			Gross Carrying Capacity			Variable dimensions									
	WB	AE <sup>5)</sup>	Front	Rear	Total	Front	Rear	Total	AC	CB <sup>6)</sup>	CH <sup>7)</sup>	BL <sup>8)</sup>	BL	TL	HA <sup>9)</sup>	HA <sup>10)</sup>	TK <sup>11)</sup>	TW <sup>12)</sup>
DAY CAB	3,25	1,70	2756	1300	4057	3244	9200	11943	0,28	0,12	1,88	3,94	4,20	6,28	1,09	0,94	11,84	12,99
	3,50	1,85	2768	1340	4108	3232	9160	11892	0,28	0,12	1,88	4,30	4,59	6,68	1,09	0,94	12,48	13,65
	3,80	2,03	2759	1349	4108	3241	9151	11892	0,28	0,12	1,88	4,73	5,04	7,16	1,09	0,94	13,26	14,44
	4,20	2,27	2753	1371	4124	3247	9129	11876	0,28	0,12	1,88	5,31	5,65	7,80	1,09	0,94	14,29	15,50
	4,50	2,45	2773	1414	4187	3227	9086	11814	0,28	0,12	1,88	5,74	6,11	8,28	1,09	0,94	15,07	16,29
	4,80	2,63	2765	1424	4189	3235	9076	11811	0,28	0,12	1,88	6,18	6,57	8,76	1,09	0,94	15,86	17,08
	5,35	2,96	2775	1467	4242	3225	9033	11758	0,28	0,12	1,88	6,97	7,41	9,64	1,09	0,94	17,29	18,53
	5,90	3,29	2784	1511	4295	3216	8989	11705	0,28	0,12	1,88	7,76	8,25	10,52	1,09	0,95	18,73	19,99
SLEEPER CAB	6,30	3,53	2787	1534	4322	3213	8966	11678	0,28	0,12	1,88	8,34	8,87	11,16	1,09	0,95	19,78	21,05
	6,70	2,90	2878	1593	4471	3122	8907	11530	0,28	0,12	1,88	8,99	9,54	10,93	1,09	0,97	20,83	22,10
	3,25	1,70	2862	1320	4182	3138	9180	11818	0,68	0,07	1,88	3,28	3,55	6,28	1,09	0,93	11,84	12,99
	3,50	1,85	2875	1359	4233	3125	9141	11767	0,68	0,07	1,88	3,65	3,93	6,68	1,09	0,93	12,48	13,65
	3,80	2,03	2867	1366	4233	3133	9134	11767	0,68	0,07	1,88	4,08	4,39	7,16	1,09	0,93	13,26	14,44
	4,20	2,27	2863	1387	4249	3137	9113	11751	0,68	0,07	1,88	4,66	5,00	7,80	1,09	0,93	14,29	15,50
	4,50	2,45	2883	1429	4312	3117	9071	11688	0,68	0,07	1,88	5,10	5,47	8,28	1,09	0,94	15,07	16,29
	4,80	2,63	2876	1438	4314	3124	9062	11686	0,68	0,07	1,88	5,54	5,94	8,76	1,09	0,94	15,86	17,08
SLEEPER CAB	5,35	2,96	2888	1479	4367	3112	9021	11633	0,68	0,07	1,88	6,34	6,80	9,64	1,09	0,94	17,29	18,53
	5,90	3,29	2898	1522	4421	3102	8978	11580	0,68	0,07	1,88	7,15	7,64	10,52	1,09	0,94	18,73	19,99
	6,30	3,53	2902	1545	4447	3098	8955	11553	0,68	0,07	1,88	7,73	8,25	11,16	1,09	0,94	19,78	21,05
	6,70	2,90	2993	1603	4596	3007	8897	11404	0,68	0,07	1,88	8,38	8,95	10,93	1,09	0,96	20,83	22,10

OTHER DIMENSIONS VA: 1,33 HV<sup>13)</sup>: 1,02 HV<sup>14)</sup>: 0,93 RB: 0,79 SB: 1,75 TB<sup>15)</sup>: 2,35

- GVM in conformity with registration documents.
- GCM in conformity with registration documents.
- Axle load with standard tyre size.
- Chassis and cab weight calculated with: Standard specification items only with 0 litres of fuel, 0 litres of AdBlue® and driver of 75 kg, tolerance ± 3%. Changing of the specification can have major impact on vehicle weight.
- Other AE dimensions may be available for shown WB. Modify rear overhang to the calculated body length.
- CB is based on standard air intake and/or exhaust.
- Cab height is measured from frame member to closed cabin roof hatch.
- Calculate customer specific body length with TOPEC. Body lengths shown based on evenly distributed load at max axle load.
- Unladen height at centre of driven axle(s).
- Laden height at centre of driven axle(s).
- TK = turning circle between kerbs.
- TW = turning circle between walls.
- Unladen height at centre of front axle(s).
- Laden height at centre of front axle(s).
- TB is overall width at rear. (At centre of front axle 255).

Depending on the vehicle configuration a specific option may not be possible. The availability and specification of this vehicle may differ per country. For further information please contact the DAF organisation. Pictures and technical illustrations are not binding in detail and can differ from the standard specification. Subject to modification without prior notice.